

CGx Series 1 & 2 Trim and Gas Controls

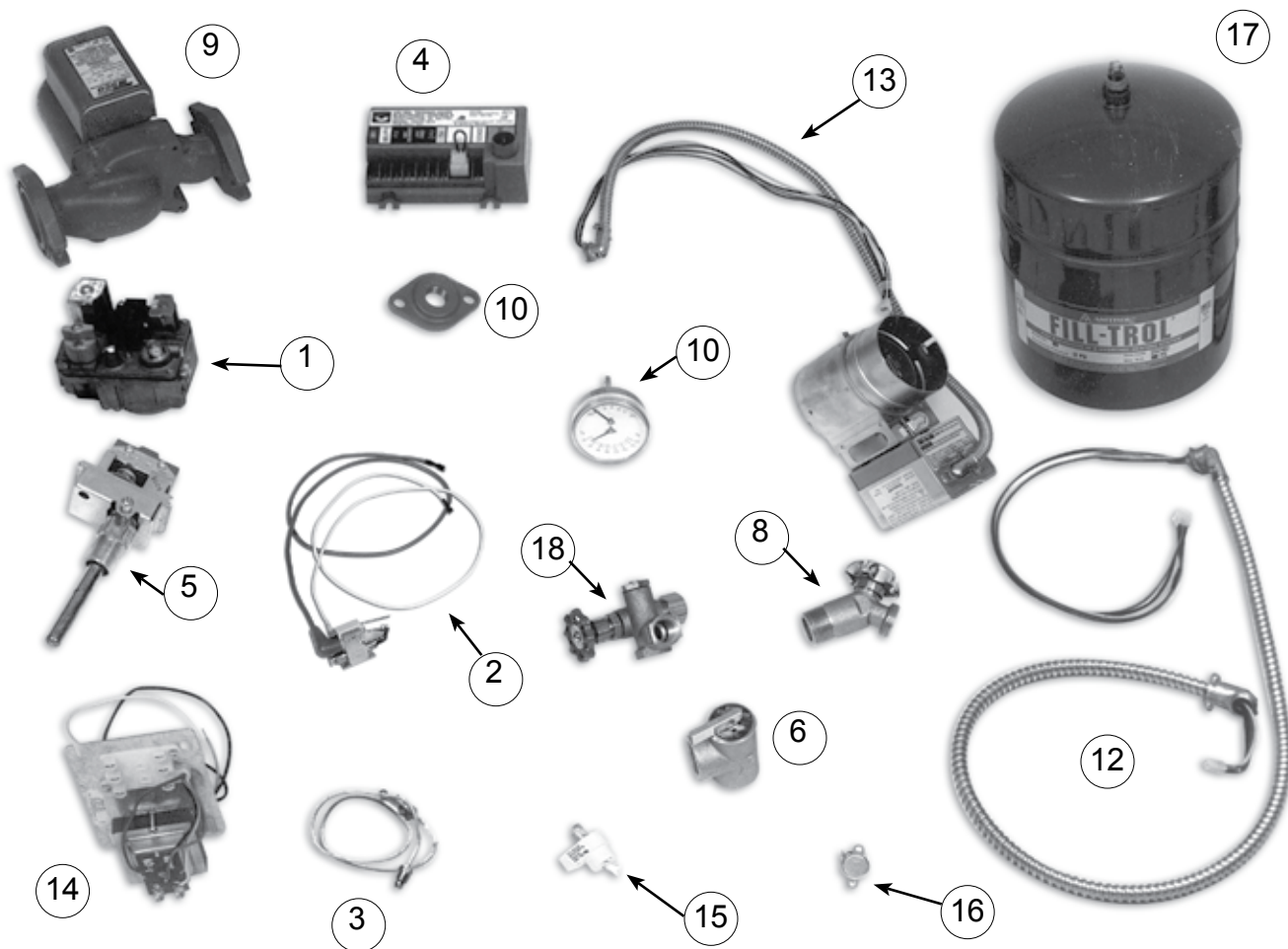

Fig. No.	Part No.	Description	Mfr.	Mfr's Part No.
1	511-044-381	Combination Gas Control Valve, ½" X ½" N.P.T., 24 Volt	Honeywell	VR8204A2001
			Robertshaw	7D1-D5B-029
			White-Rodgers	36E36-266-S1
2	511-330-218	Pilot Assembly Kit with orifice, aluminum pilot gas tubing, and spark wire and sense wire	Precision Speed Equip.	PSE-NA16
3	560-742-860	Pilot Tubing, 1/8" O.D. X 22-3/4" with Fittings	Weil-McLain	
4	511-330-095	Ignition Sensing Control Module with Damper Molex, 24 Volt, (Series 1)	United Technologies	1003-510
			Honeywell	S8620C1011
	511-330-097	Ignition Sensing Control Module without Damper Molex, 24 Volt, (Series 2)	United Technologies	1003-511
			Honeywell	S8620C1003
5	510-312-250	High Limit Temperature Control, 30°F Fixed Subtractive Differential with ½" N.P.T. Well, Automatic Recycle, 140-240°F Range	Honeywell	L4080D1036
			White-Rodgers	11B81-3

CGx Series 1 & 2 Trim and Gas Controls

6	511-546-921	Relief Valve (Male) 30 PSIG, 3/4" N.P.T.	Conbraco	10-407-10
			Watts	350
	511-546-924	Relief Valve (Female) 30 PSIG, 3/4" N.P.T.	Watts	335
			Conbraco	10-408-05
7	380-000-000	Combination Pressure-Temperature Gauge, 3" Dia., 0-75 PSIG, 60-320°F, short shank, back connection, 1/4" N.P.T.	Amekai	OS234-JDTW-001
8	511-210-423	Drain Valve, 3/4" N.P.T., 1-1/2" Shank	Conbraco	31-606-01
9	511-405-113	Circulator, 1/25 HP, 120/60/1	Taco	007
	511-405-115	Circulator, 1/12 HP, 120/60/1	Bell & Gossett	100
10	511-405-535	Circulator Gasket	Weil-McLain	
11	381-354-525	Circulator Hardware Kit (Includes: 1 flange, 2 bolts, 2 nuts, Diamond gasket, 1" N.P.T.)	Weil-McLain	
	381-354-526	Circulator Hardware Kit (Includes: 1 flange, 2 bolts, 2 nuts, Diamond gasket, 1 1/4" N.P.T.)	Weil-McLain	
	591-319-793	Wiring Harness Circulator	Weil-McLain	
12	591-391-795	Vent Damper Wiring Harness	Weil-McLain	
	510-512-337	Vent Damper Motor Operator with Molex	Effikal	RVGP
	510-312-255		Johnson Controls	M345BE-1C
13	381-800-474	Automatic Vent Damper Assembly, 4", CGx-3	Feld Controls	GVD-4
			Effikal	RVGP-KS-4BKF
	381-800-475	Automatic Vent Damper Assembly, 5", CGx-4	Feld Controls	GVD-5
			Effikal	RVGP-KS-5BKF
381-800-476	Automatic Vent Damper Assembly, 6", CGx-5, 6	Feld Controls	GVD-6	
		Effikal	RVGP-KS-6BKF	
	510-312-167	Combination Transformer and DPST relay, 120/24 Volt, 40 VA	Honeywell	R8285D1000
14	510-312-166	Combination Transformer-Relay Receptacle, 120/24 Volt, 40VA	White-Rodgers	S84A85
	510-350-223	Plug-In Relay, SPDT, with 24 Volt Holding Coil	White-Rodgers	91-322000-11000
			Honeywell	R8222U1006
			Products Unlimited	9001-241Q223
15	512-050-230	Rollout Thermal Fuse, 228°C	Elmwood Sensors	RD226-001
16	510-300-014	Spill Switch with Manual Reset, 240°F CG-3 thru 8	Elmwood Sensors	2455RM-8050-0181
17	510-632-088	Fill-Trol Diaphragm Expansion Tank	Amtrol	109
	510-632-089	Fill-Trol Diaphragm Expansion Tank	Amtrol	110
18	511-210-433	Fill Valve Angle Style-90 with Built-in Strainer, Pressure Reducer, Check Valve and Manual Shut-Off	Conbraco	MX3907
	591-391-863	Wiring Harness CG, CGx (Series 2 Only) See Note	Weil-McLain	

Note: Series 1 uses individual wires and not a wire harness